

Appendix C
9. Traffic Calming

Traffic Calming

Transportation Policy Committee
January 15, 2013

What is “Traffic Calming”?

- ❖ “Traffic calming involves changes in street alignment, installation of barriers, and other **physical measures** to reduce traffic speeds and/or cut-through volumes, in the interest of street safety, livability, and other public purposes.”

Institute of Transportation Engineers

- ❖ Traffic calming does not include speed limits, enforcement, education, or other non-physical measures.

Traffic Calming Goals

- ❖ Apply physical, engineered measures to compel drivers to slow down and to decrease traffic volumes;
- ❖ Implement self-enforcing rather than regulatory measures;
- ❖ Reduce cut-through traffic;
- ❖ Increase the safety of children, pedestrians, bicyclists, and motorists;
- ❖ Maximize street life and pedestrian activity;
- ❖ Prevent crime; and
- ❖ Enhance urban redevelopment.

Federal Highway Administration

Types of Traffic Calming Measures

- ❖ Volume control
- ❖ Speed control
 - Vertical measures
 - Horizontal measures
 - Street/lane narrowings
 - Number of lanes

Volume Control (Access Restriction)

Full Closure

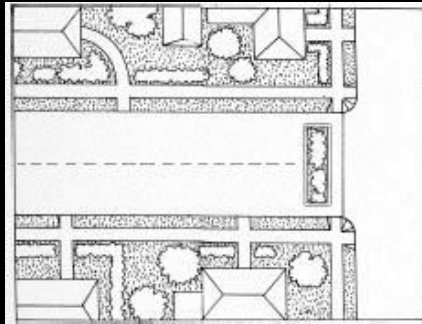

Half Closure

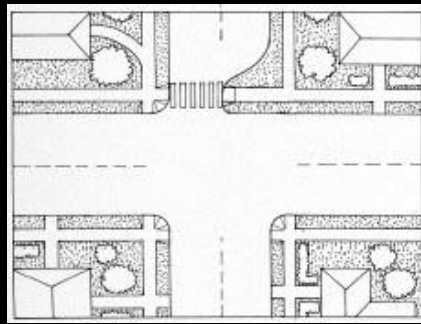

Half Closure



Volume Control (Access Restriction)

Median Barrier

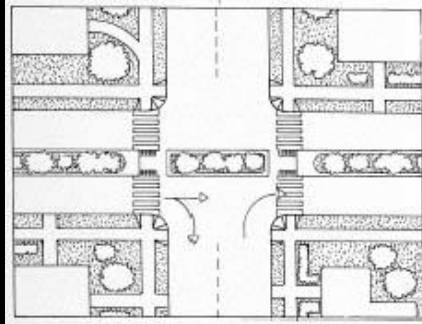

Forced Turn Island

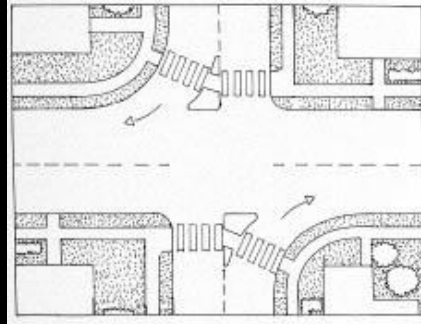

Vertical Deflection

Speed Hump

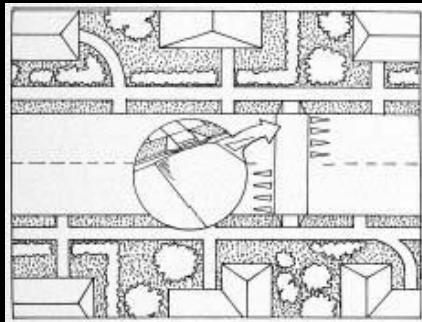

Speed Table / Raised Crosswalk

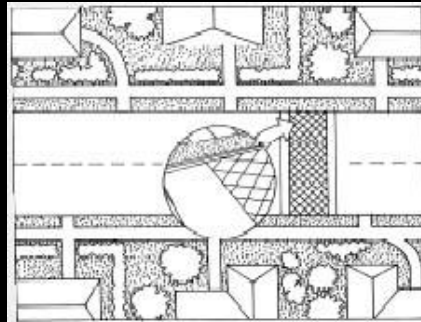

Speed Hump



Speed Table / Raised Crosswalk



Vertical Deflection

Speed Cushions



Vertical Deflection

Raised Intersection

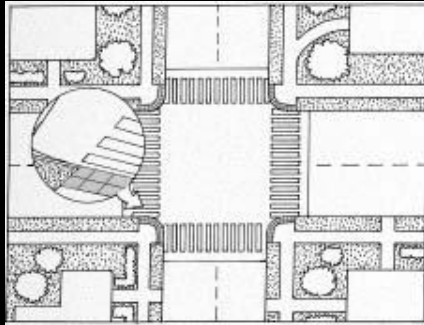

Surface Material / Texture

Textured Pavement

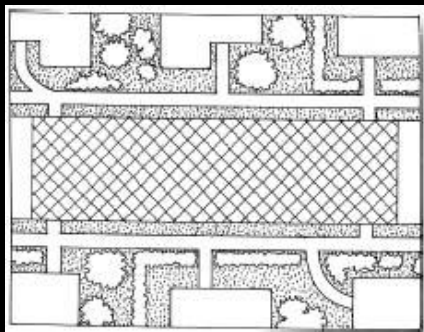

Horizontal Deflection

Roundabout

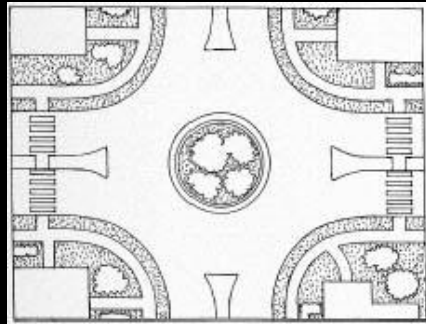

Neighborhood Traffic Circle

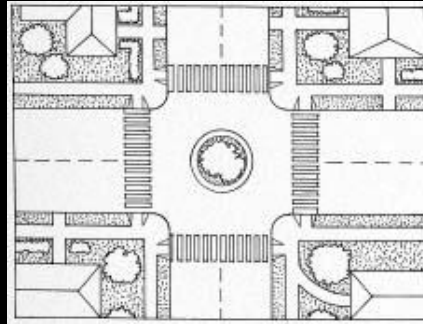

Roundabout



Neighborhood Traffic Circle



Neighborhood Traffic Circle



Horizontal Deflection

Lateral Shift

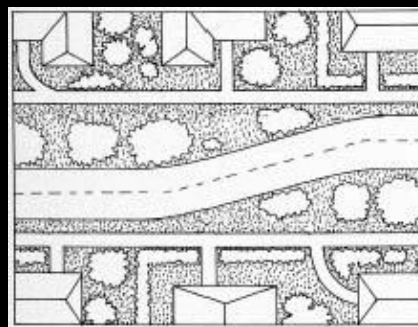

Chicane

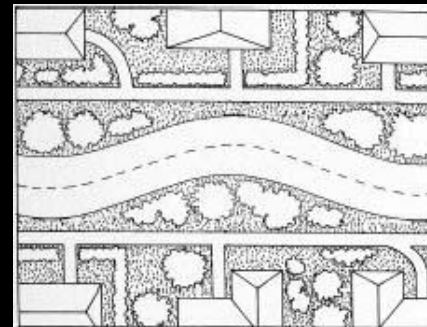

Narrowing

Curb Extension

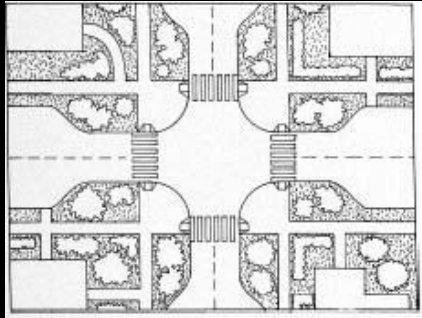

Choker

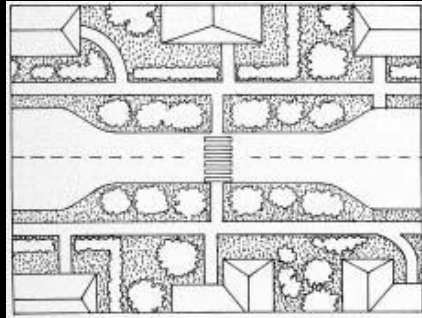

Narrowing

Center Island Narrowing and Pedestrian Refuge

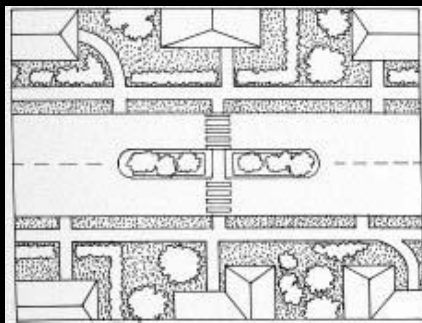

Number of Lanes

❖ Road diet

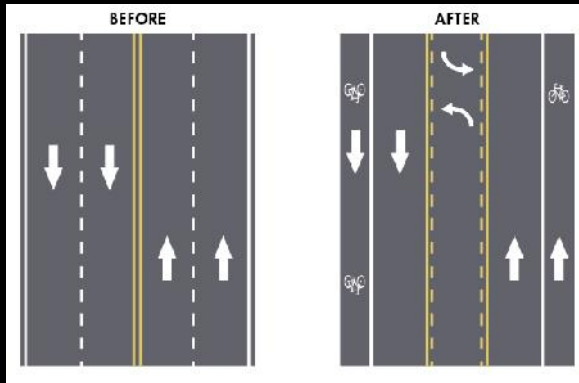

❖ One-way to two-way conversion

Road Diet

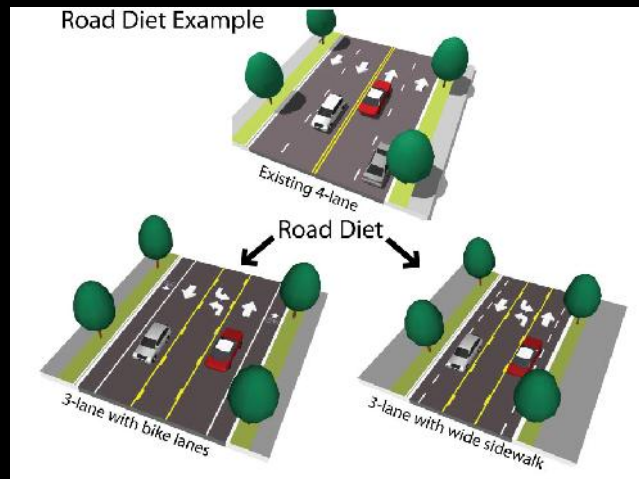

Traffic Calming Device	Major Arterial	Minor Arterial	Major Collector	Neighborhood Collector
Roundabouts	No	No	Yes	Yes
Traffic Circles	No	No	No	Yes
Raised Crosswalks	No	No	Yes	Yes
Curb Extensions	No	Yes	Yes	Yes
Parking Bays	Yes	Yes	Yes	Yes
Chicanes	No	Yes	Yes	Yes
Street Closure	No	No	No	No
Half Diarter	No	No	No	No
Diagonal Diarter	No	No	No	No
Star Diarter	No	No	No	No
Raised Median	Yes	Yes	Yes	Yes
Pavement Surface Modification	Yes	Yes	Yes	Yes
Speed Actuated Signaling	No	No	No	No
Speed Humps	No	No	No	No
Speed Tables	No	No	No	Yes
Landscape Roadway	No	Yes	Yes	Yes
Midblock Stockpiles	No	No	Yes	Yes
Angled Slow Point with Median	No	No	Yes	Yes

Figure 6-8. Traffic Calming Eligibility on Major Streets (Eugene, Ore.)